

**Instructions for Use
SYMPAZAN (SIM-pa-zan)
(clobazam)
oral film, CIV**

Read this Instructions for Use before you start using SYMPAZAN and each time you get a refill. There may be new information. The information does not take the place of talking with your healthcare provider about your medical condition or treatment.

Important Information for Patient and Caregiver:

- **Do not take SYMPAZAN** until:
 - you have read and understand these instructions.
 - you have reviewed the steps with your healthcare provider on how to take it.
 - you know the right time, how often, and the dose to take.
 - you feel comfortable with how to use SYMPAZAN.
- If you are not sure about giving treatment or when to give treatment, **call your healthcare provider** before using **SYMPAZAN**.

How should I store SYMPAZAN?

- Store SYMPAZAN at room temperature between 68°F to 77°F (20°C to 25°C).
- Keep SYMPAZAN in the foil pouch until you are ready to use. Use right away after opening foil pouch.
- **Keep SYMPAZAN and all medicines out of the reach of children.**

How to Use SYMPAZAN:

- Take only 1 SYMPAZAN film at a time unless instructed differently by your healthcare provider. If a second film is needed to get a full dose of SYMPAZAN, do not take the second film until the first film has completely dissolved.
- **Place the entire SYMPAZAN oral film on top of the tongue.** Check your prescription or contact your healthcare provider if you are not sure about the amount to take.
- Make sure your hands are clean and dry before handling the SYMPAZAN film.
- Check the expiration date printed on the foil pouch. **Do not** use SYMPAZAN if expired.

Step 1. Open Pouch

- Fold foil pouch along solid line.
- Note where the slit is and carefully tear it to open pouch.

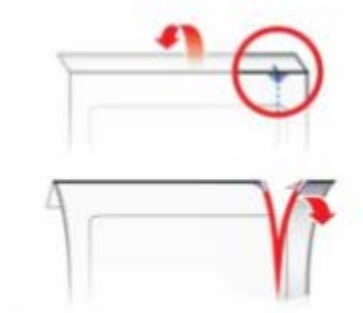

Step 2. Remove Film

- Remove the SYMPAZAN from the foil pouch.

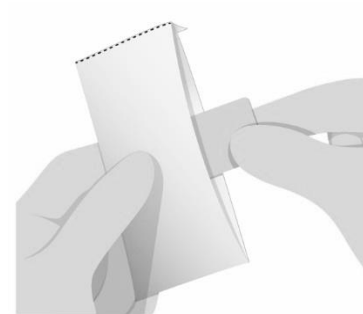

Step 3. Place on Tongue

- Place SYMPAZAN on top of the tongue. The film will stick to the tongue and begin to dissolve.



Step 4. Close Mouth and Swallow Saliva Normally

- Close mouth.
- Swallow saliva normally as SYMPAZAN dissolves.
- **Do not** take with liquids.
- **Do not** chew, spit, or talk while SYMPAZAN dissolves.



- **Wash your hands after taking SYMPAZAN.**
- **Throw away the empty foil pouch in the regular trash.**

Manufactured by:

Aquestive Therapeutics

Warren, NJ 07059

For more information or support about SYMPAZAN: Call 1-833-AQUESTV (1-833-278-3788).

This Instructions for Use has been approved by the U.S. Food and Drug Administration.

Revision Date: 11/2018